

## Cosy Cement Board XPS300 300KPA Tile Backer Board

The **CosyFloor** pre-routed, cement-coated XPS panel, designed for use with water-based underfloor heating systems. These overlay panels are made from high-density XPS (300 kPa), which is thermally insulating, lightweight, waterproof, and faced with a reinforced cement coating. The panels offer a quick and easy solution for the placement of pipework in both domestic and commercial underfloor heating applications. The lightweight, reinforced cement facing provides a robust surface that is ideal for direct bonding of tiles.

Many other types of finish, such as engineered wood, carpet, vinyl, etc., can also be used with additional preparation of the panels.

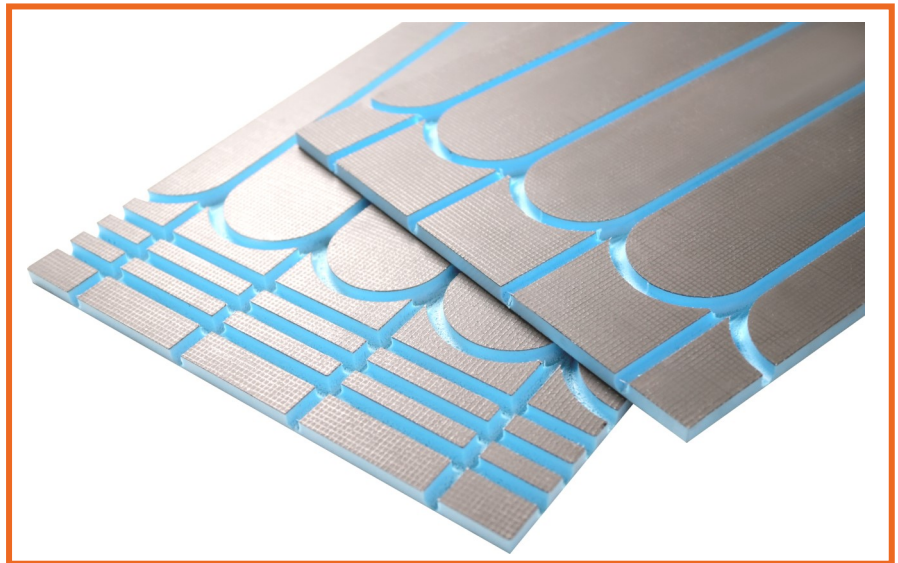

### Dimensions For 300Kpa Board for 16mm Pipe

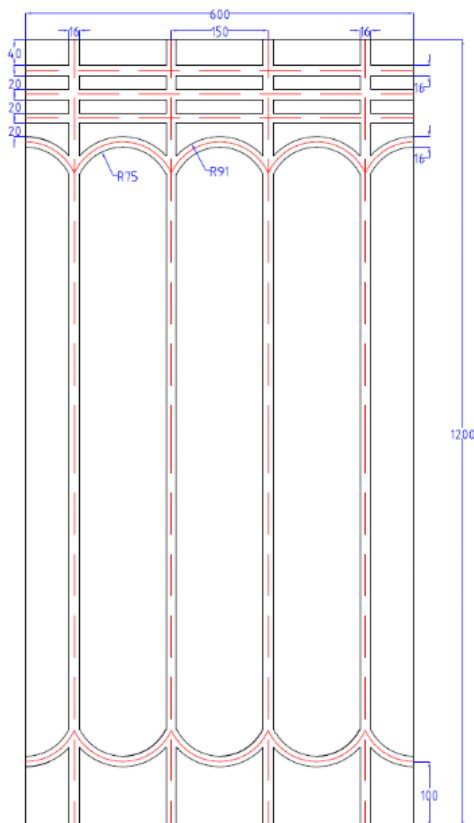

### Performance

Extruded Polystyrene-XPS	High Strength UFH Board
Strength at 10% compression	300 kpa
Thermal conductivity	0.033 W/mK
Temperature range	-50 / +75 °C
Density (foam core only)	33 kg/m <sup>3</sup>
Pipe centres	150 mm
Board Size	600 x 1200 x 20(mm)
Fire-retardant class	Europe E Class
Thickness/weight	20mm/2.6kg
Sound Reduction	20dB
Water Absorption by volume tested to BSEN 12087	0.8%
Output at 50°C	80 W/m <sup>2</sup>
Recommended Flow Temp	45°C to 55°C

### Key Benefits



Suitable for all types of floor finish including ceramic tiles



Low profile system has minimal impact on floor height



Provides an efficient and even spread of heat across the floor



Optimises the performance of wet underfloor heating system

### Size

- Cosy Cement Board XPS300 1200x600x20mm 150cc 16mm Pipe

**CosyFloor** Cement Board 300KPA XPS Tile Backer Board with Cementitious Face is exclusively available at UFH Supplies Ltd Trading as **CosyFloor**

01455 247 782 - sales@cosy-floor.co.uk - www.cosyfloor.co.uk